

# Technical Specification

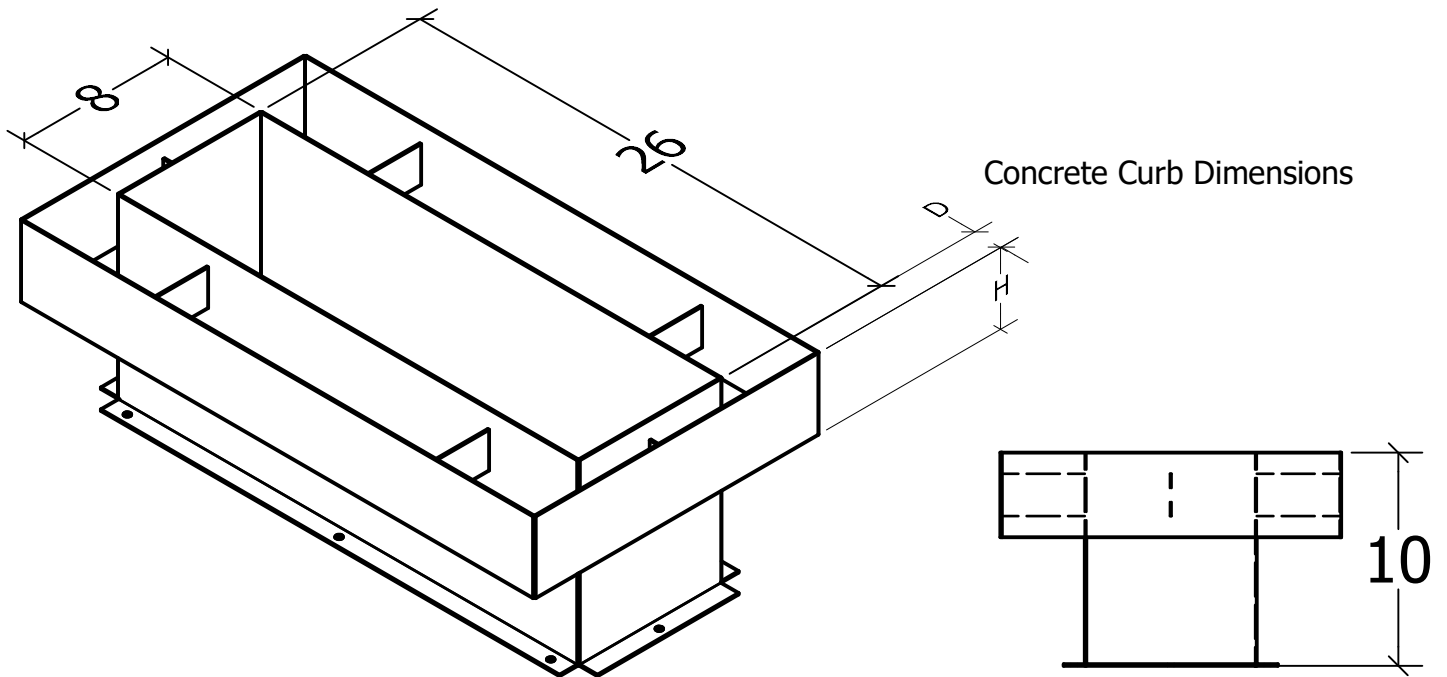

## BUS DUCT CURB

- Bus duct curb is constructed of 16 or 14 gauge galvanized sheet steel.
- Bus duct curb is constructed with all welded seams.
- Bus duct curb dimensions are fully customizable.
- $\frac{5}{16}$ "  $\varnothing$  mounting holes provided

DWG. TITLE:

BUS DUCT CURB

DWG. NO.:

190214

MATERIAL:

16/14 Gauge Galvanized steel

FINISH:

GALVANIZED

### NOTICE:

THIS INFORMATION IS THE PROPERTY OF N.J. SULLIVAN CO., ANY REPRODUCTION, PUBLICATION OR DISTRIBUTION TO A THIRD PARTY IS STRICTLY FORBIDDEN UNLESS WRITTEN PERMISSIONS ARE GIVEN BY AN AUTHORIZED AGENT OF:  
N.J. SULLIVAN CO., INC.

DFTG.: Adam Martin DATE: 190214

CHKR.: DATE:

REV.: DATE:

REV.: DATE:

REV.: DATE:

**N.J.**  
SULLIVAN Co.

INCORPORATED

P.O. BOX 438, STERLING, VIRGINIA 20167

METAL FABRICATION

Phone: (703)-464-5994

Fax: (703)-464-5992

www.njsullivan.com